

REVISION RECORD			
REV	ECN.	DESCRIPTION	DRFT DATE

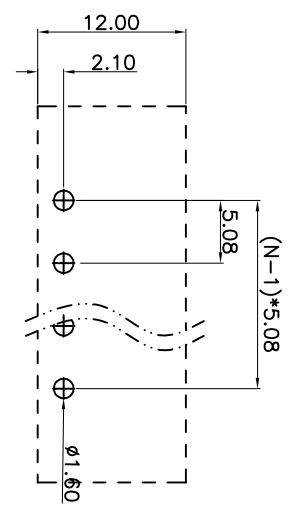
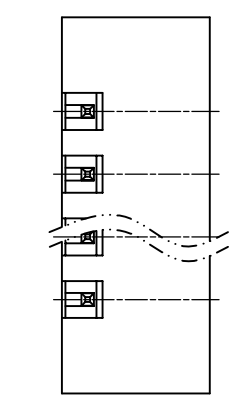
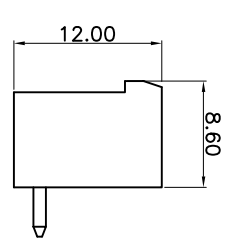
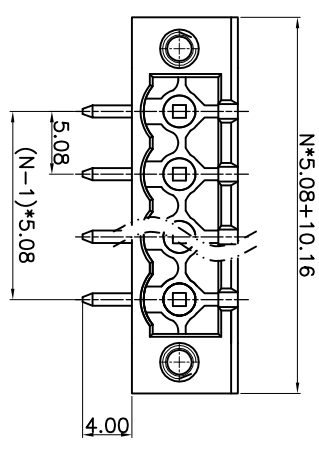

PCB LAYOUT

N=No.of contacts

间距公差 (mm)	标准公差 (mm)	公差带
≤6	±0.10	±0.10
6 ~ 10	±0.20	±0.20
10 ~ 24	±0.30	±0.30
≤30	±0.40	±0.40
30 ~ 60	±0.50	±0.50
60 ~ 100	±0.60	±0.60
100 ~ 150	±0.70	±0.70
150 ~ 200	±1.00	±1.00
≥200	±1.00	±1.00

- NOTE 1:
UL标准 (UL Standard)
1. 额定电压与电流: 300V/15A
Rated voltage/Rated current: 300V/15A
2. 功频耐压: AC1600V/Min
Withstanding Voltage: AC1600V/Min
IEC标准 (IEC Standard)
1. 额定电压与电流: 320V/20A
Rated voltage/Rated current: 320V/20A
- NOTE 2:
1. 间距 (Pitch): 5.08mm
2. 使用温度范围: -40°C~+105°C
Operating temperature: -40°C~+105°C
3. 符合RoSH环保要求
RoHS Compliance
5. 未标注公差表
Undimensioned tolerances

订购方式 (HOW TO ORDER)
MX2EDGRM-5.08-□□P-□□□□

- Series NO. Pitch Poles 颜色 (Color)
1. 单间距 Single Pitch
2. 双间距 Double Pitch
1. 灰色 (Gray) 2. 蓝色 (Blue)
3. 黑色 (Black) 4. 绿色 (Green)
5. 橙色 (Orange) 6. 红色 (Red)
7. 黄色 (Yellow) 8. 白色 (White)
9. 透明 (Transparent)

2	(Pin header) 焊脚 (Copper alloy) 铜合金	(Sn plated) 镀锡 UL94V-0
1	(Housing) 塑件 PA66	UL94V-0

PART NO.:		/	
APPD:		/	
CHKD:		/	
DRFT:		/	
THIED ANGLE PROJECTION			
型号	MX2EDGRM-5.08-XXP	系列	MX2EDGRM-5.08
图号	MX2EDGRM508001	页码	1/1
		比例	1:1

宁波迈科思电子科技有限公司
NINGBO MAX ELECTRONIC TECHNOLOGY CO.,LTD