

RoHS Compliant

Customer Drawing

| REV. | ECN NO. | DESCRIPTION | DATE | DESIGN |
|------|---------|-------------|------|--------|
| | | | | |

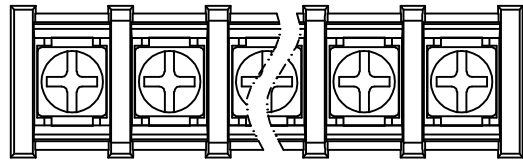

·材质及电镀(Material)
 塑件(Housing): PA66, UL94V-0
 端子(Terminal): 黄铜, 0.7μ 镀锡(Brass, Tin plated)
 螺丝(Screw): M3, 钢, 镀锌(Steel, Ni-Plated)

·电气性能(Electrical)
 额定电压(Rated Voltage): 300V
 额定电流(Rated Current): 20A
 绝缘电阻(Insulation Resistance): 500MΩ/DC500V
 耐电压(Withstanding Voltage): AC2000V/Min

·机械性能(Mechanical)
 温度范围(Temperature Range): -40℃~ +105℃
 适用线径(Wire Range): 22-14AWG
 最大扭矩值(Max.Torque Value): 0.5N.m 4.4Lb.in

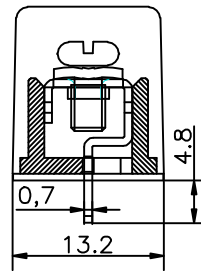
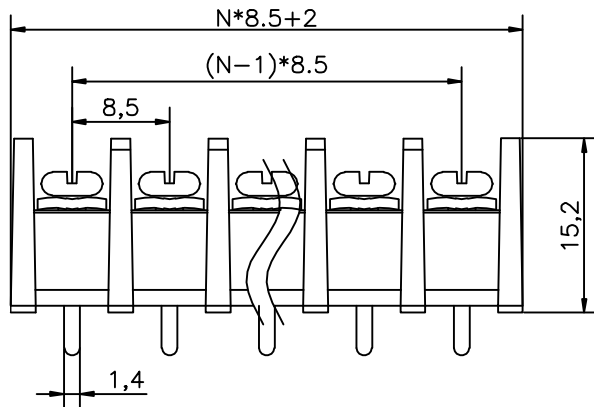

订购方式/HOW TO ORDER

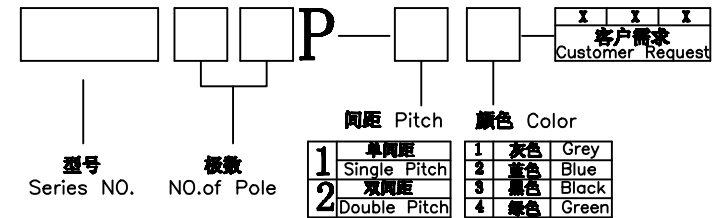

CONTACT WITH US:
 TEL: +86-574-63505128 FAX: +86-574-63532183
 E-Mail: sales@nbmax.com.cn Website: www.nbmax.com.cn

N=No. of contacts

| 公差一览表 | | | | 宁波迈科思电子科技有限公司 | | | | | |
|----------------------------|-------|-------|-------|--|------------|---------------|-----|------------------|--------------|
| TOLERANCE UNLESS OTHERWISE | | | | NINGBO MKX ELECTRONIC TECHNOLOGY CO.,LTD | | | | | |
| X. | ±0.25 | X° | ±5° | 单位 UNITS | mm | 制图 DRAWING | 陈冬梅 | 产品名称 TITLE | MX35C-8.50 |
| .X | ±0.20 | .X° | ±2° | 角法 VIEW | | 设计 DESIGN | 顾兴伟 | 产品料号 PART NO. | MX35C-8.50 |
| .XX | ±0.15 | .XX° | ±1° | 比例 SCALE | 1:1 | 审核 CHKD | | 图号 DRAW NO. | MX35C-8.5-0A |
| .XXX | ±0.02 | .XXX° | ±0.5° | 日期 DATE | 2012.07.10 | 版本 VER | A0 | 核准 APPD | |